

Gipro Mount

Instructions manual

Fully adjustable handlebar mount for Gipro



1 Choose the proper shim

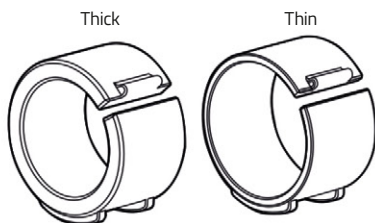

Disassemble the clamp. Separate the plastic shims and unroll the thin shim. Depending on the target tube diameter, select the right shim and place on the handlebar.

21-23mm (7/8") : Thick Shim
24-26mm (1") : Thin Shim
27-29mm (9/8") : Without Shim

2 Place the clamp on the bar

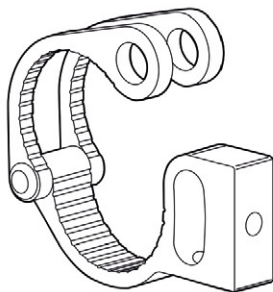

Wind the arm around the target tube then close.
If a plastic shim is used, rotate it into proper position.

3 Insert the pin

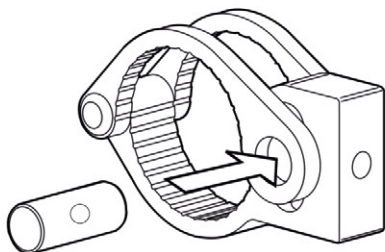

Slide the pin in place, making sure the threaded hole is aligned with the bolt hole.

4 Fasten the clamp

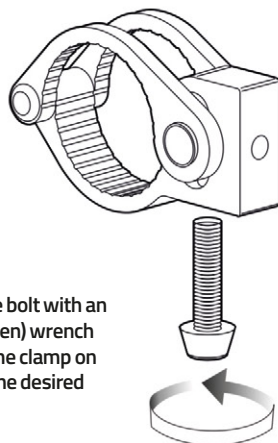

Tighten the bolt with an M5 hex (Allen) wrench to secure the clamp on the bar in the desired position.

5 Cut the tape cover

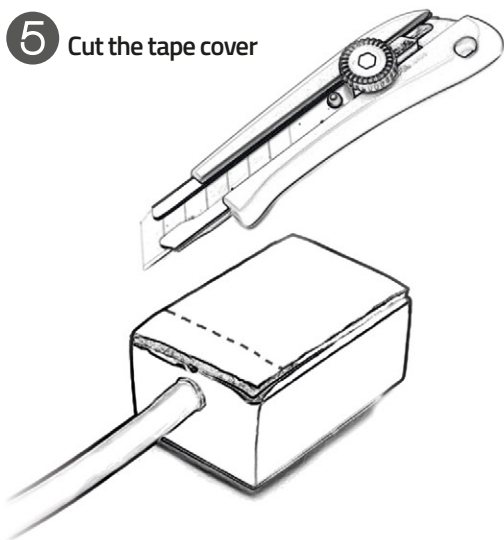

Cut the green plastic tape cover (foil) at the back side of the Glpro unit as shown.

6 Remove the tape cover

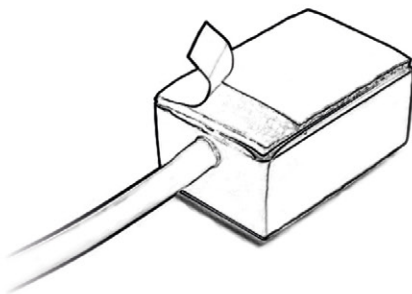

Remove the smaller portion of the green plastic tape cover. Keep the larger portion on the unit. Do NOT remove the whole cover, otherwise you will not be able to remove the display from the mount later.

7 Mount the housing

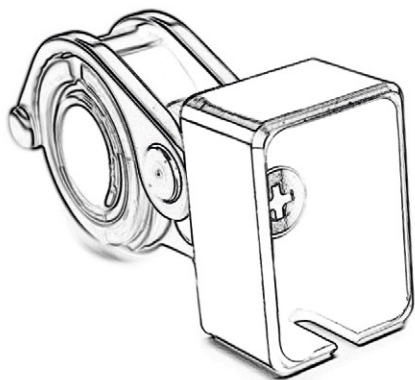

Remove the bolt from the clamp, place the housing in the desired position and fasten the bolt.

8 Place the unit in the mount



Put the Glpro unit into the housing and push it firmly for a few seconds. If you ever need to remove the Glpro from the housing, use a small flat head screwdriver to lift it up. Do NOT pull the cable!